

NOTE: AT ENTRY POINTS TO SHARED ZONES THE RAMP GRADE IS INCREASED TO BETWEEN 1:2 AND 1:4

SECTION A-A

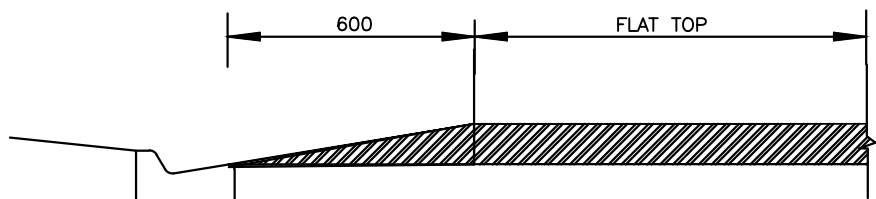

SECTION B-B

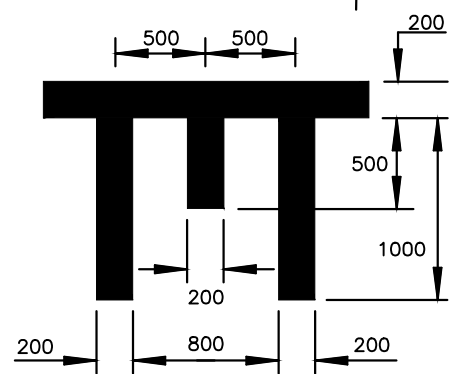

DETAIL A

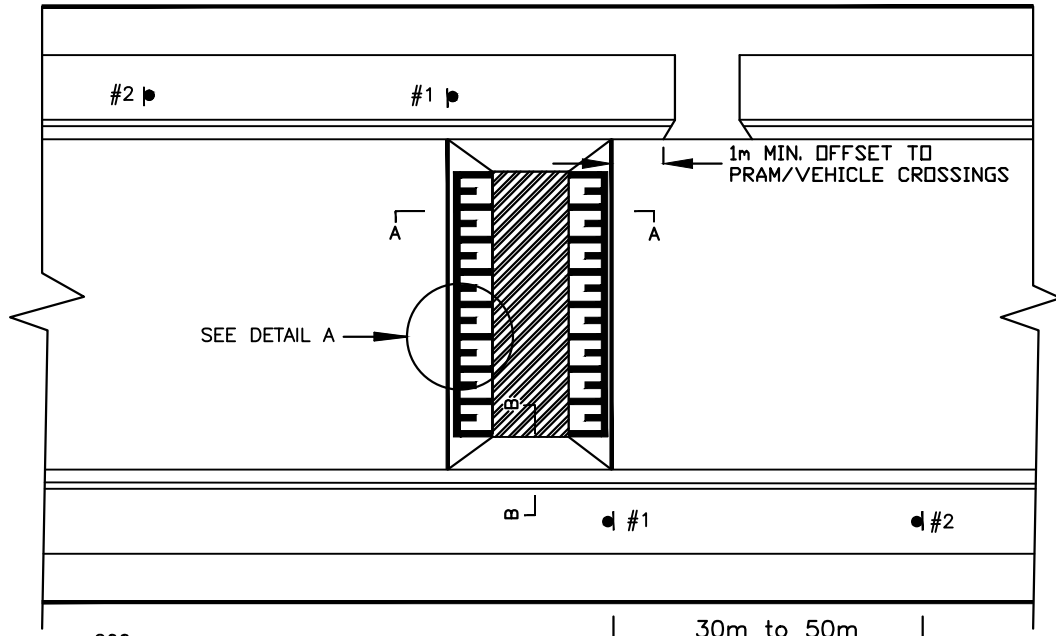

PLAN
FLAT TOP ROAD HUMPS
NOT TO SCALE

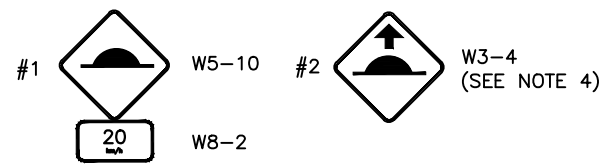

SIGN SCHEDULE

NOTES

1. LONGITUDINAL LINE MARKING (CENTRE & PARKING LANE LINES) TO BE 3mm THICKNESS THERMO APPLIED PLASTIC.
2. RAISED PAVEMENT LINE MARKING TO BE 2mm THICKNESS COLD APPLIED PLASTIC.
3. ROAD SIGNS TO BE INSTALLED IN ACCORDANCE WITH SD 823.
4. 'RAISED PAVEMENT AHEAD' WARNING SIGN (W3-4) TO BE USED IN ADVANCE OF AN ISOLATED RAISED PAVEMENT AND AT THE START OF A SERIES OF RAISED PAVEMENTS.
5. APPROPRIATE STREET LIGHTING MUST BE PROVIDED TO SUFFICIENTLY DELINEATE RAISED PAVEMENTS.
6. ALL DIMENSIONS ARE IN MILLIMETRES UNLESS NOTED OTHERWISE.
7. TO BE INSTALLED TOGETHER WITH WEARING COURSE ASPHALT.

City of Whittlesea		
RAISED PAVEMENT PROFILE		SD 621
APPROVED:	DATE: 17/06/2014	REV: A